

ROOM 202, O'DOWD HALL**Current Situation**

The current configuration of Room 202 ODH (below) is not well suited for holding classes. It is a very large, tiered space with over 400 seats, with the distance from the upper seats to the instructor being about 70 feet. As a large space, the acoustics do not provide an environment conducive to classroom use. Since there is not an ongoing requirement for a space this large, and there is a growing need for the larger classroom capacity, the room is used as a classroom for classes of 40 - 100 students. The faculty and students do not prefer instruction in this room, due to its shortcomings as classroom space.

After many discussions among University staff and outside consultants concerning the possibilities for improving the utility of Room 202, it appears that dividing the large, cavernous space into three large classrooms is feasible. This new configuration would, in essence, provide three times the effective classroom capability that the current room contains. Each of the three new classrooms would contain:

- 80 – 90 tiered seats
- Level III AV Instructional Technology
- ADA accessibility for both faculty and students
- Updated seating to replace fiberglass swivel seats
- Separate entrances/exits
- Utility system modification for individual classroom control

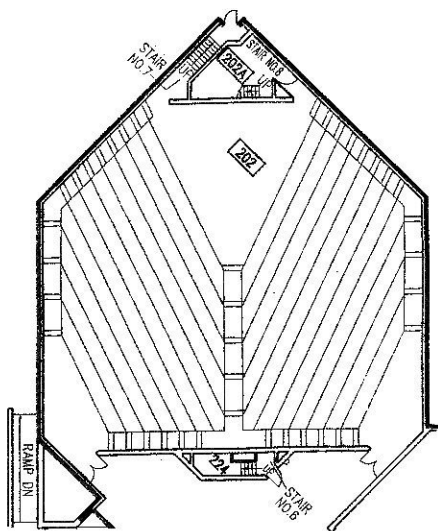

CURRENT CONFIGURATION

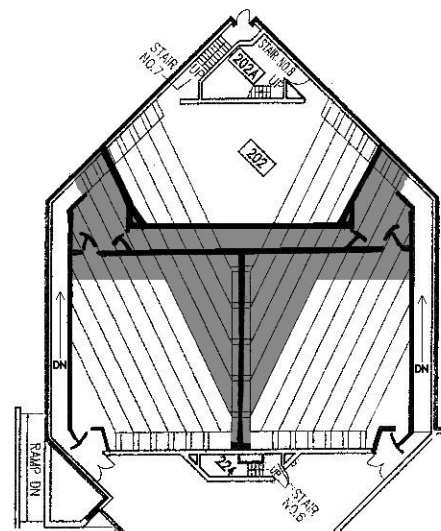

PROPOSED CONFIGURATION